



GENUINE PARTS

INSTALLATION INSTRUCTIONS

DESCRIPTION:	Splash Guard - Front Kit
APPLICATION:	Q50
PART NUMBER:	999J2 J2xxx03 (xx Designates color)

KIT CONTENTS:

Item	Qty.	Part Description	Service Part Number
A	1	Splash Guard - Front Right	---
B	1	Splash Guard - Front Left	---
C	1	Installation Instruction Replacement Template	999V2 AW000
D	1	Installation Hardware Kit	---
E	4	• Spring Nut M5	12-41 01011
F	8	• Phillips Screw M5 x 20mm	14-51 00891

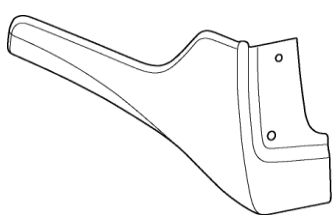

A

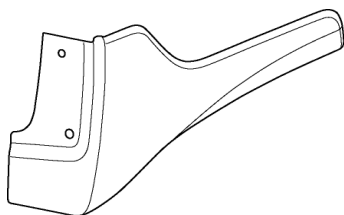

B



C

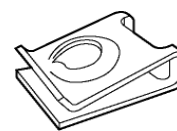

E



F

TOOLS REQUIRED:

- Phillips head short screwdriver
- Drill
- 3 mm (1/8"), and 6mm (1/4") drill bit
- Masking tape
- Clean, lint-free wiping cloth
- Mild soap / water mixture
- 90% or greater alcohol

PRE-INSTALLATION WARNINGS, CAUTIONS, CRITICAL STEPS, and NOTES:

- Dealer Installation Recommended. Instructions may refer to Service Manual.
- These instructions are for left side of vehicle; same procedure applies to right side.

⚠ CAUTION

- Install the splash guards when the ambient temperature is above 60°F (15°C).
- Do not wash or expose the vehicle to a wet environment for 24 hours after installing the splash guards.

INSTALLATION PROCEDURE:

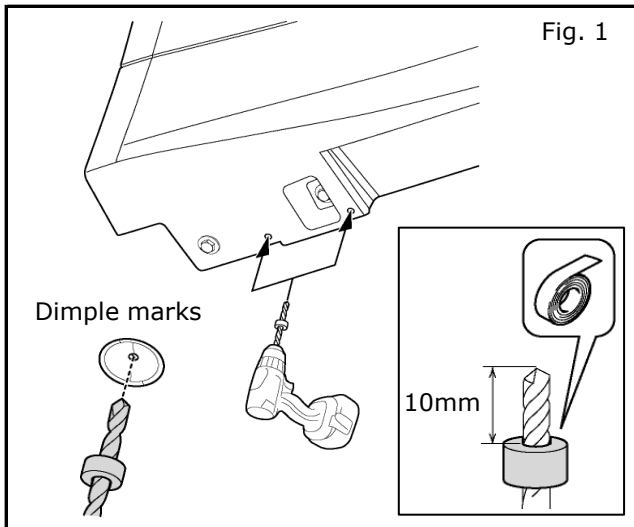

- 1) Turn wheel to access front screws.
- 2) Jack up vehicle to access bottom screws.
- 3) Drill 3mm(1/8")→6mm(1/4") holes at 2 marked locations.
- 4) Lower the vehicle.

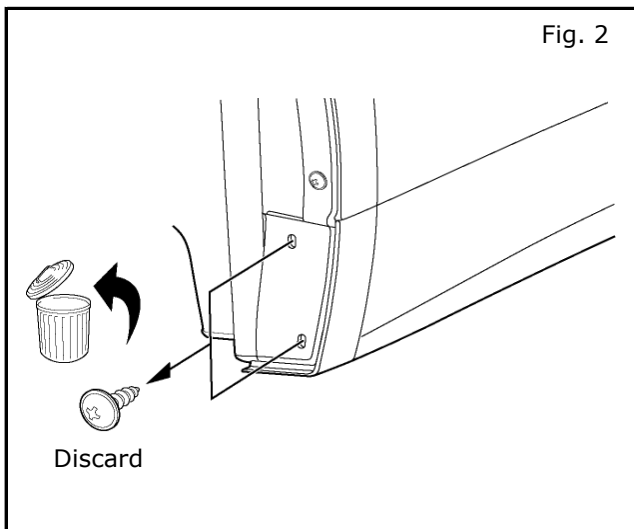

- 5) Remove screws from fender protector and discard.

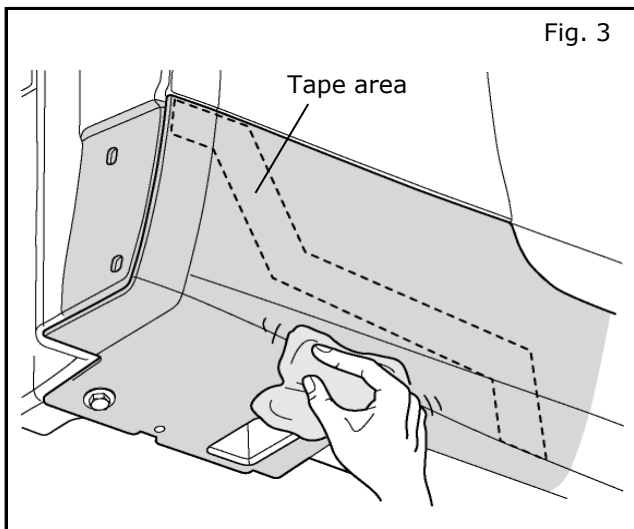

- 6) Clean installation surface (shaded area) with mild soap/ water mixture.
- 7) Using a clean, lint free cloth, wipe tape area with 90% or greater alcohol.

INSTALLATION PROCEDURE:

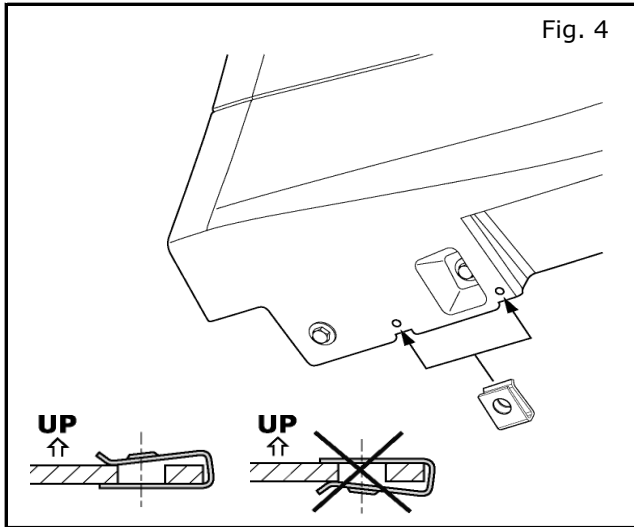

8) Install spring nuts(E).

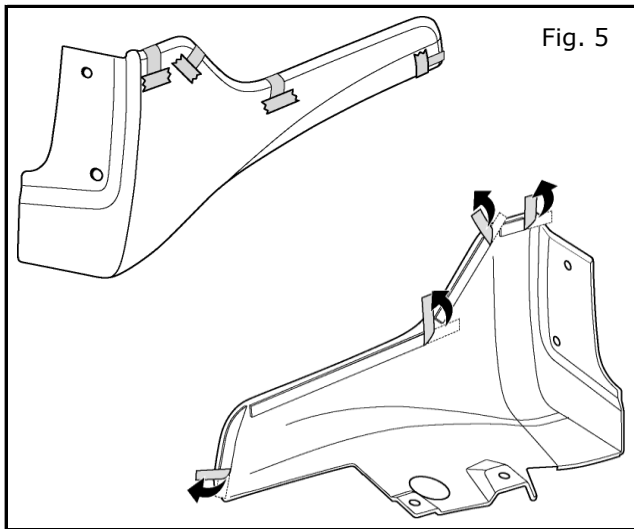

9) Fold tape liner pull tabs onto front splash guard surface and apply masking tape to ensure that pull tabs are accessible.

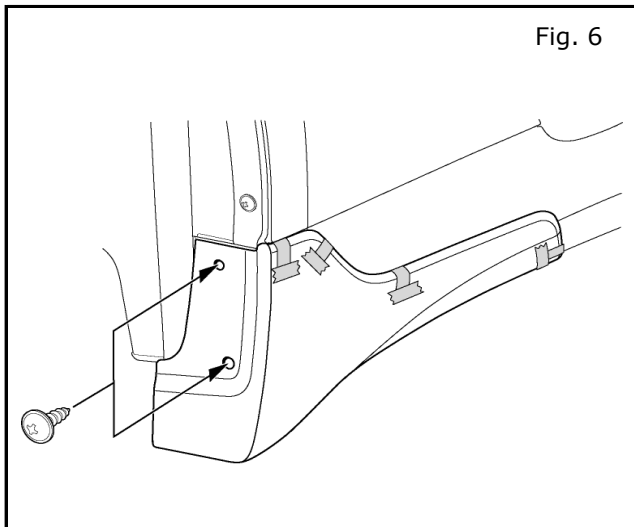

10) Align front splash guard to vehicle and loosely install phillips screws(F).

INSTALLATION PROCEDURE:

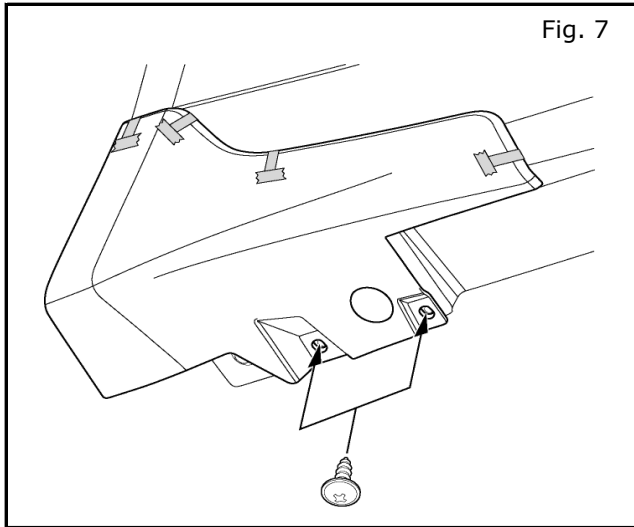

11) Align front splash guard to vehicle and loosely install phillips screws(F).

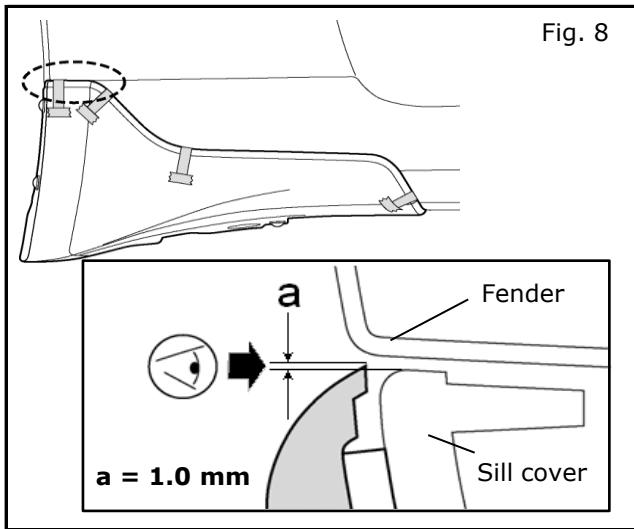

12) Align front splash guard 1mm above sill cover.

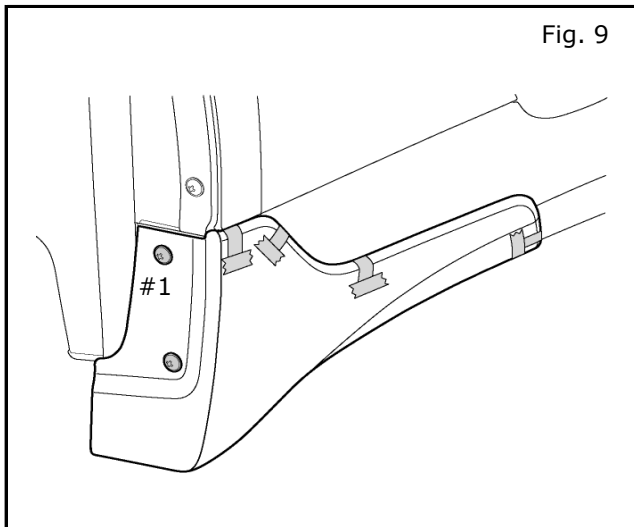

13) While keeping alignment in Fig 8, tighten phillips screw (F) #1 shown in Fig. 9.

NOTE:

Do not over tighten screws. Reference Tighten Torque: 3.8~4.4 N-m {34~39 in-lb}

INSTALLATION PROCEDURE:

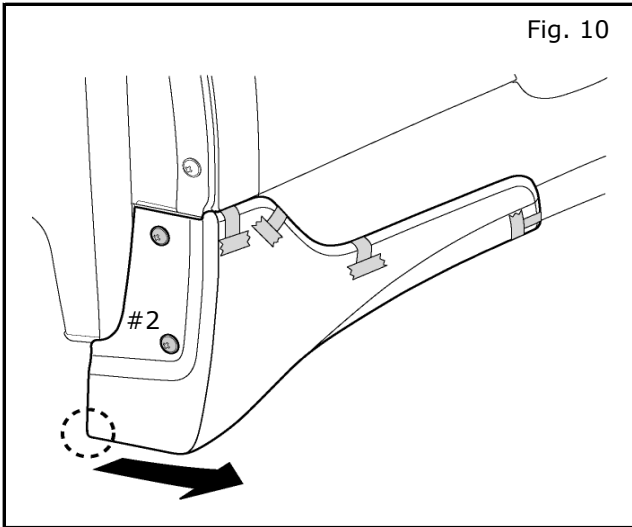

- 14) While pulling splash guard from bottom, tighten phillips screw (F) #2 as shown in Fig. 10.

NOTE:

Do not over tighten screws. Reference Tighten Torque: 3.8~4.4 N-m {34~39 in-lb}

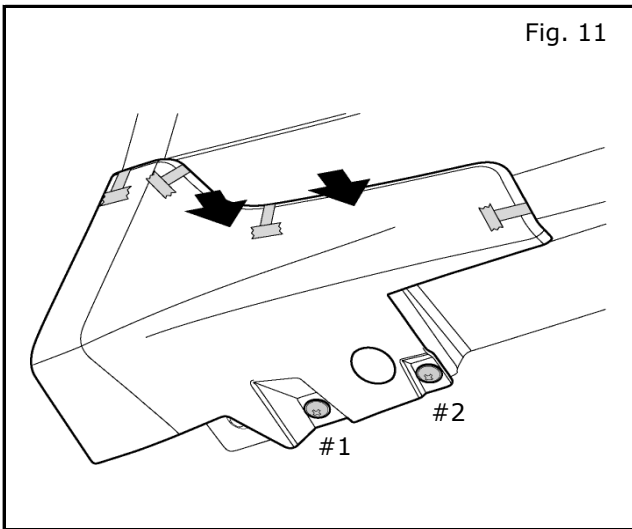

- 15) While holding splash guard against vehicle, tighten phillips screws (F) #1 & #2 in sequence shown Fig.11.

NOTE:

Do not over tighten screws. Reference Tighten Torque: 3.8~4.4 N-m {34~39 in-lb}

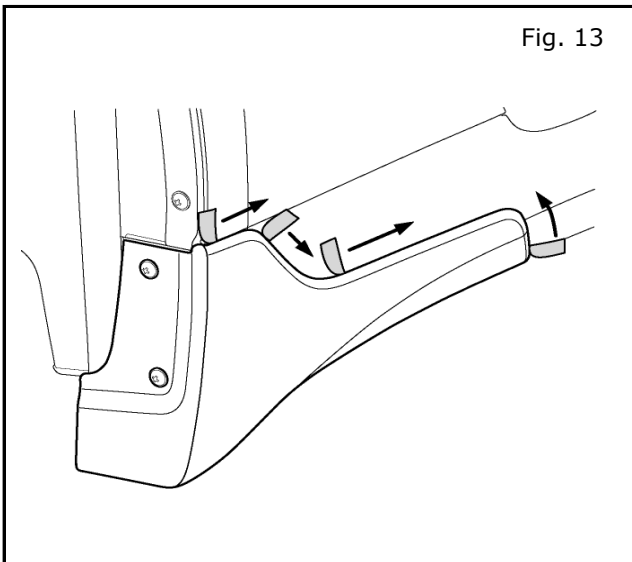

- 16) Remove tape liner in direction shown by arrow.

INSTALLATION PROCEDURE:

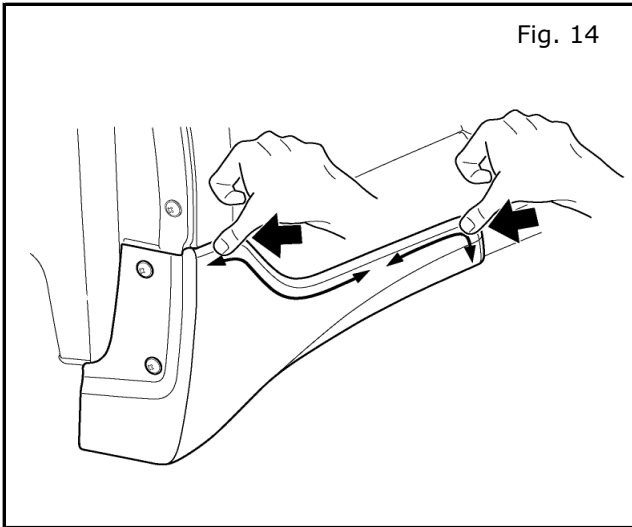

17) Apply at least 15lbs of pressure to front splash guard to ensure that tape is attached.

NOTE:

Use a roller or burnish by hand with a rag and apply a minimum of 15lbs of pressure along length of tape.

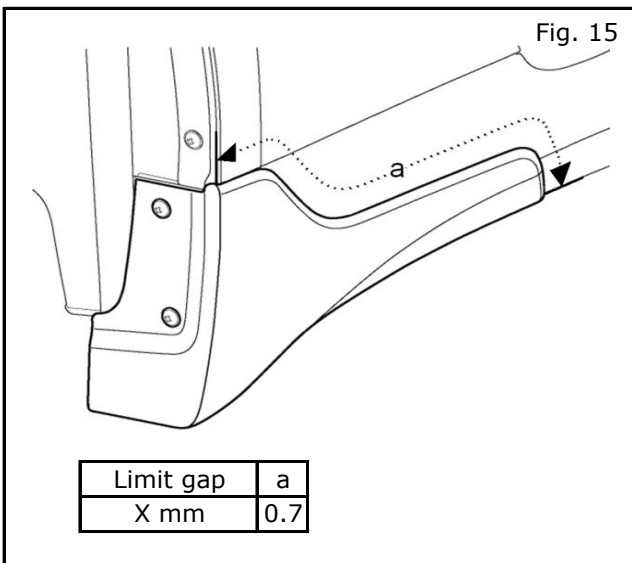

ACCESSORY CHECK:

- Check all torque values.
- Check gap. See Fig.15.
- Clean the fenders and sill covers near the installation areas of the vehicle.

FINAL INSPECTION:

- Verify exterior is not damaged.